

Pressure transmitters with ceramic measuring cell

ATM/K



Version: 07.01.2016

Technische Spezifikationen

Pressure measuring range (bar)

	0.1	0.2 / 0.4	1
Überlast	4 bar	6 bar	10 bar
Accuracy, (1), (\pm % FS)	≤ 0.25	≤ 0.25	≤ 0.25
Thermal shift, (\pm % FS/$^{\circ}$C)			
Zero point -20 ... 80 $^{\circ}$ C	≤ 0.01	≤ 0.01	≤ 0.01
Span -20 ... 80 $^{\circ}$ C	≤ 0.01	≤ 0.01	≤ 0.01
Long term stability, (2)	< 0.15 % FS	< 0.15 % FS	< 0.15 % FS

	2	4	10 / 20
Überlast	18 bar	25 bar	40 bar
Accuracy, (1), (\pm % FS)	≤ 0.25	≤ 0.25	≤ 0.25
Thermal shift, (\pm % FS/$^{\circ}$C)			
Zero point -20 ... 80 $^{\circ}$ C	≤ 0.01	≤ 0.01	≤ 0.01
Span -20 ... 80 $^{\circ}$ C	≤ 0.01	≤ 0.01	≤ 0.01
Long term stability, (2)	< 0.15 % FS	< 0.15 % FS	< 0.15 % FS

(1) Zero based accuracy according to DIN-16086, incl. hysteresis and repeatability at ambient temperature

(2) 1 year (typ.)

Temperature range

Operating temperature	-25 ... 85 $^{\circ}$ C
Process temperatur	-40 ... 125 $^{\circ}$ C
Storage temperatur	-25 ... 85 $^{\circ}$ C

Electrical specifications

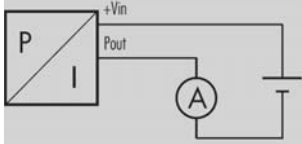
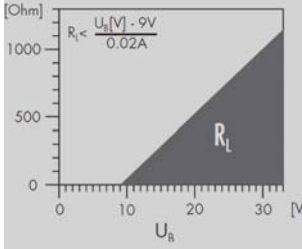
	4 ... 20 mA
Power supply, (1)	9 ... 30 VDC
Supply influence	< 0.1% FS
Circuit diagram	
Load resistance	
Load influence	< 0.1% FS

(1) Power supply with optional surge (lightning) protection: 15 ... 30 VDC

Qualifications

	Description	Level	Typical interferences
EN 61000-4-2	Electrostatic discharge	4 kV contact 8 kV air	
EN 61000-4-3	Irradiated RF	10V/m (0.08...1 GHz)	Radio sets, wireless phones
EN 61000-4-4	Transients (burst)	2 kV	Motors, valves
EN 61000-4-5, (1)	Surge	10 kA (8 / 20 µs)	Overvoltage
EN 61000-4-6	Conducted RF	10 V (0.15 ... 80 MHz)	Frequency converters

(1) Only with optional overvoltage protection

Physikalische Spezifikationen

Materials	
Transducer	Ceramic Al ₂ O ₃ (96%)
Housing	Stainless steel (316L / 1.4404)
Seals	Viton (standard), EPDM, Kalrez

Equipment

Overview

10.00.0091	Accessories overview
HART001	Cable Socket Connector

Additional documents

Operating and safety instructions

	Article number
10.88.0092	DMM029

Ordering information

		X. XXXX.	XXXX.	XX.	XXX
Type					
	ATM/K	53			
Pressure type					
	Gauge	1			
	Absolute (vacuum)	2			
	Seald gauge	3			
Pressure measuring range					
	100 mbar ... 20 bar	XX			
Process connection					
	G 1/2 M, 10mm bore (Fig. 2)	13			
	Customized	99			
Electrical connection					
	DIN-43650, with metal threaded part, demountable, IP 65 (Fig. 10), (1)		01		
	Binder 723, 5-pin, demountable, IP 67, (Fig. 12), (1)		43		
	PUR cable, black, IP 67		15		
	PUR cable, black, submersible back IP 68		24		
	Customized		99		
Output signal					
	4 ... 20 mA		05		
Accuracy					
	$\leq \pm 0.25$ % FS			1	
Temperature range					
	-20 ... 80°C compensated (allowed process temperature: -40 ... 125°C)			3	
Option 1					
Option 2					
Option 3					
	Special version				Z

(1) Cable socket connector not included

Technical drawings

Pressure connections / Dimensions

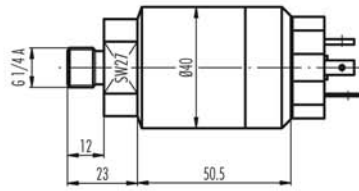

Fig. 1

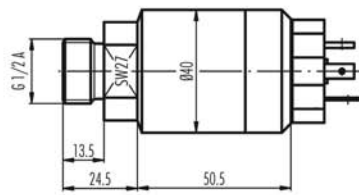

Fig. 2

Electrical connections

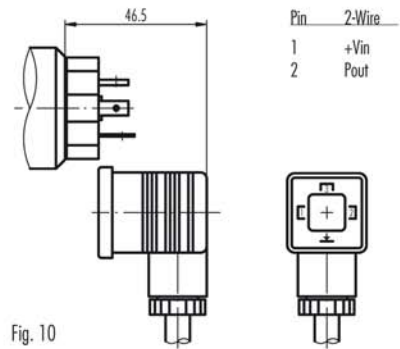

Fig. 10

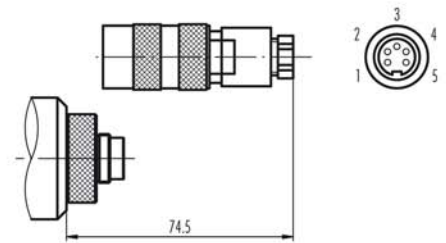

Fig. 12

Specifications may change without notice.

STS Headquarters, Switzerland:
 STS Sensor Technik Sirmach AG
 Rütihofstrasse 8, 8370 Sirmach, Switzerland
 sales@stssensors.com | www.stssensors.com

STS France:
 STS France
 844 Route de la Caille, 74350 Allonzier la Caille, France
 info-fr@stssensors.com | www.stssensors.fr

STS Germany:
 STS Sensoren Transmitter Systeme GmbH
 Poststrasse 7, 71063 Sindelfingen, Germany
 info-de@stssensors.com | www.stssensors.de

STS Great Britain:
 STS Great Britain Ltd.
 Box 3942 | Warwick | CV34 9AE, United Kingdom
 contact@stssensors.com | www.stssensors.co.uk

STS Italy:
 STS Italia s.r.l.
 Via Gesù 5, 20090 Opera (Milano), Italy
 info-italia@stssensors.com | www.stssensors.it